

PEARL

PALM BEACH SHORES

SIMPLE ELEGANCE. FLAWLESSLY EXECUTED.

Introducing a collection of 18 luxury residences.

Palm Beach Shores “The Best Little Town in Florida”

*Downtown
West Palm Beach*

*Palm Beach
International Airport*

*Safe Harbor
Rybovich Marina*

Palm Beach Island

Palm Beach Inlet

Port of Palm Beach

Peanut Island

Sailfish Marina



PEARL



- 1 Sailfish Marina & Resort
- 2 Riviera Beach & Park
- 3 Phil Foster Park & Snorkel Trail
- 4 Peanut Island Park
- 5 Publix Super Market
- 6 Safe Harbor Rybovich Riviera Beach
- 7 Port of Palm Beach & Cruise Port
- 8 St Mary's Medical Center



Stunning sunrise over the Atlantic Ocean.



The Town of Palm Beach Shores.

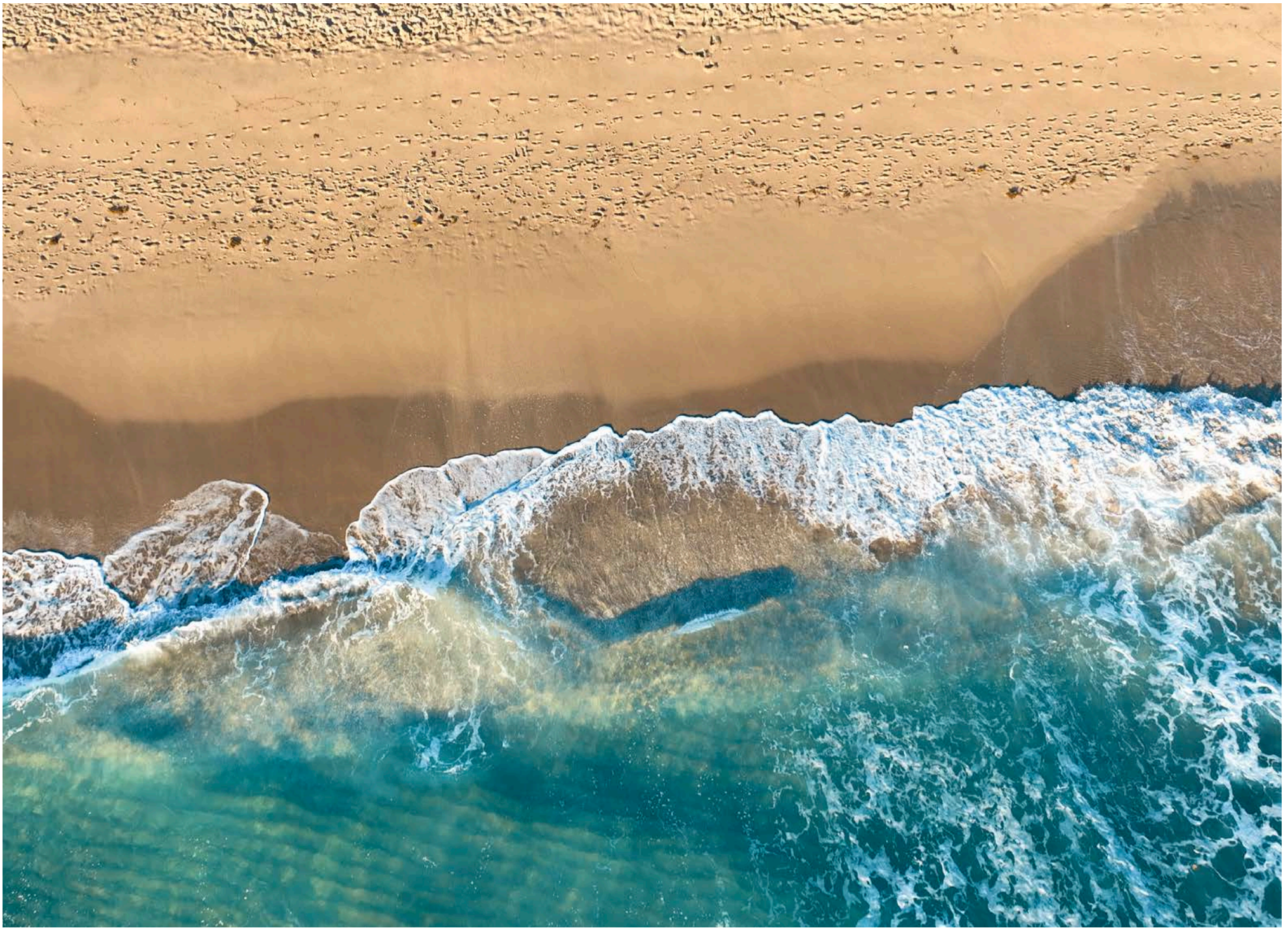

Clear blue waters of the Atlantic Ocean.



Ocean inspired living...your way.

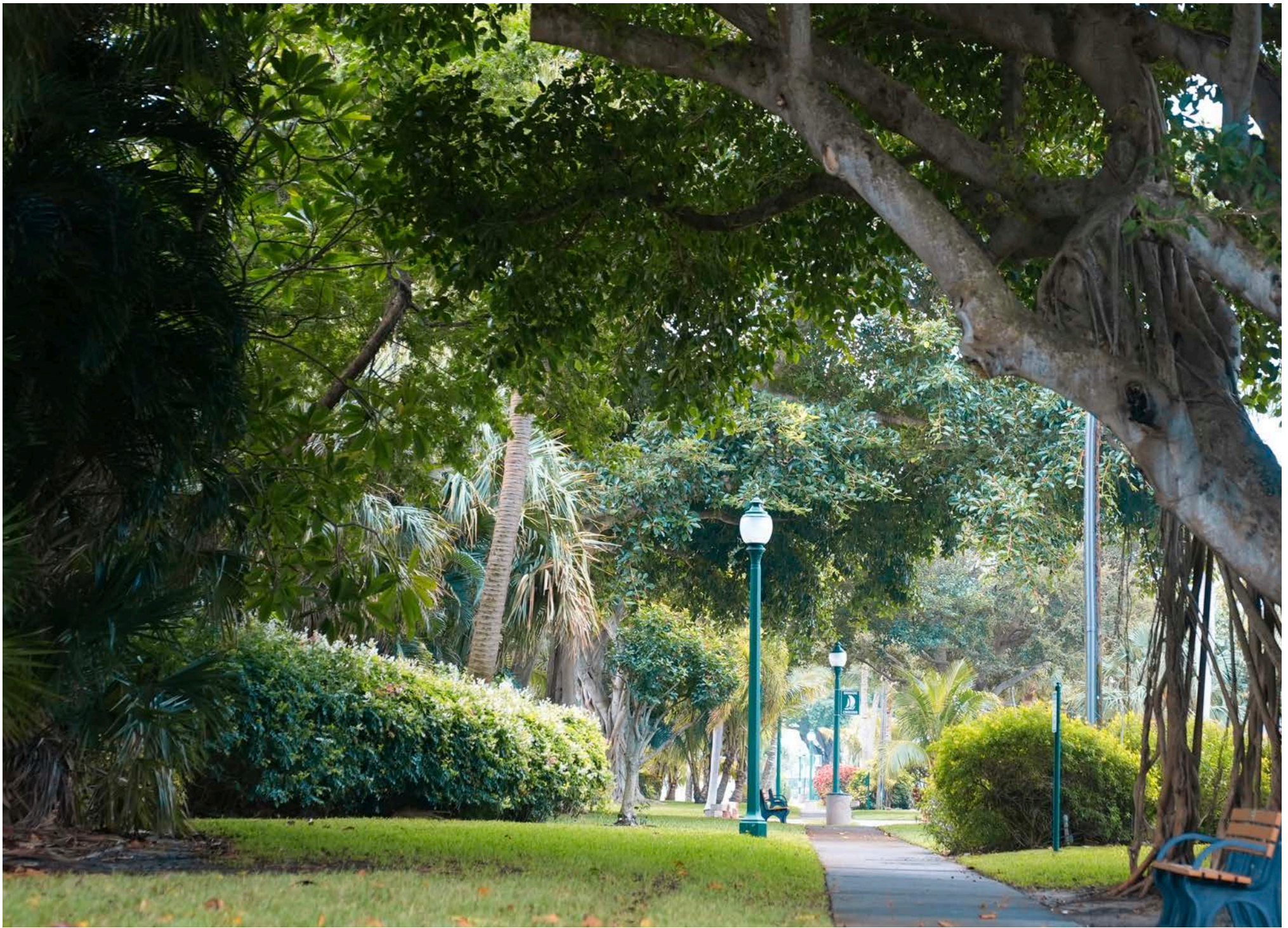

A beautiful one mile walking trail that leads to the easternmost point of Florida.



Sailfish Marina & Resort located on the western shoreline.

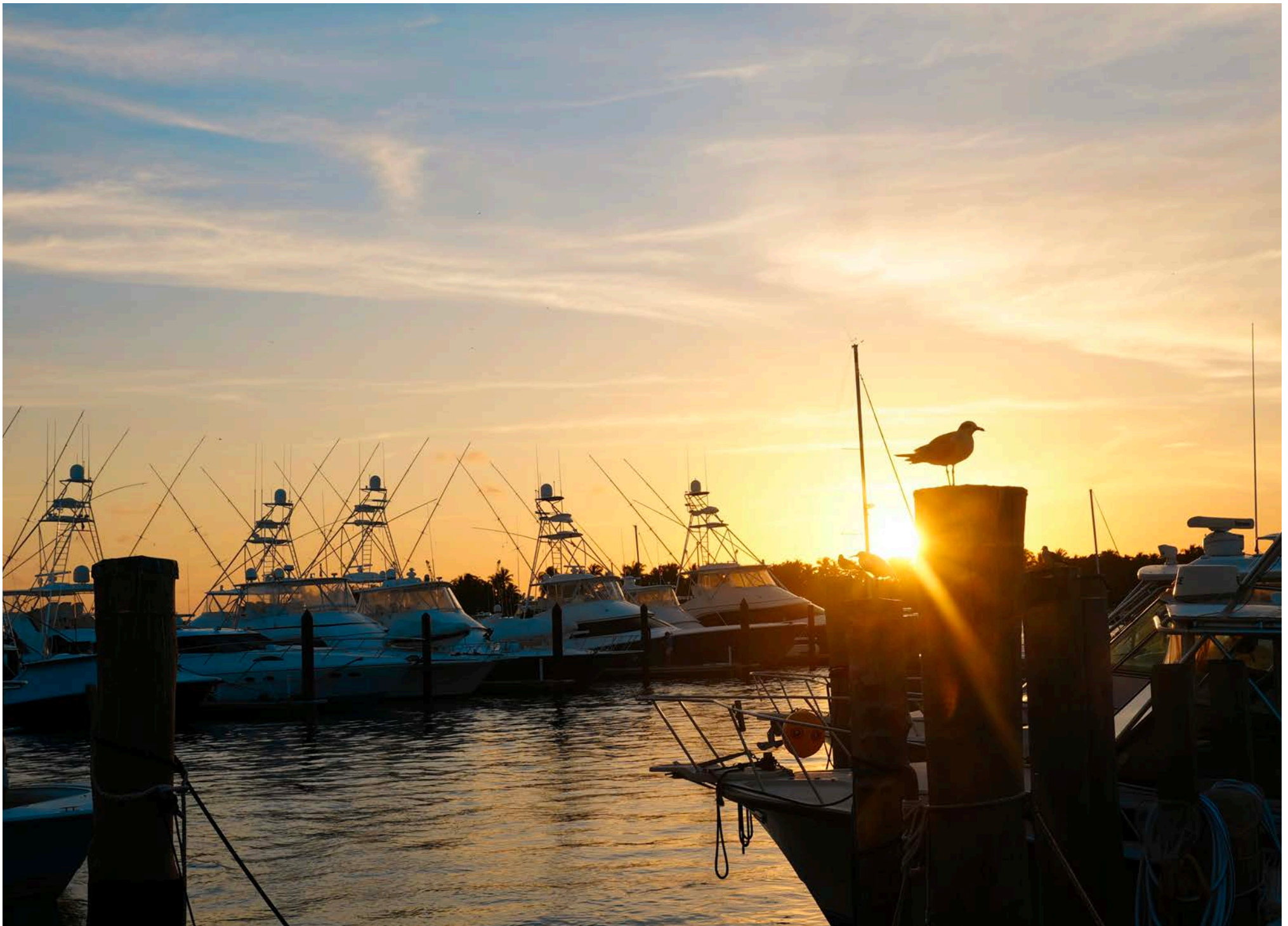

Sailfish Marina



Sunset views over the Atlantic Ocean.

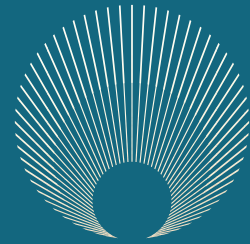

PEARL

PALM BEACH SHORES



ARTIST'S CONCEPTUAL DRAWING



ARTIST'S CONCEPTUAL DRAWING



ARTIST'S CONCEPTUAL DRAWING

LOBBY



ARTIST'S CONCEPTUAL DRAWING



ARTIST'S CONCEPTUAL DRAWING



ARTIST'S CONCEPTUAL DRAWING



RESIDENTS' LOUNGE



ARTIST'S CONCEPTUAL DRAWING

BUSINESS SUITE



ARTIST'S CONCEPTUAL DRAWING



ARTIST'S CONCEPTUAL DRAWING

FITNESS STUDIO



ARTIST'S CONCEPTUAL DRAWING



ARTIST'S CONCEPTUAL DRAWING



ARTIST'S CONCEPTUAL DRAWING

WELLNESS



ARTIST'S CONCEPTUAL DRAWING

RESIDENCE INTERIOR



ARTIST'S CONCEPTUAL DRAWING

Great Room



ARTIST'S CONCEPTUAL DRAWING

Living & Dining Room



Natural Oak Flooring



ARTIST'S CONCEPTUAL DRAWING

Kitchen



Natural Oak
Taj Mahal Quartzite
Lacquer paint
Metallic accents
European plumbing fixtures



ARTIST'S CONCEPTUAL DRAWING

Primary Bedroom



ARTIST'S CONCEPTUAL DRAWING

Primary Bedroom



ARTIST'S CONCEPTUAL DRAWING

Primary Bathroom



Natural Oak
Travertine
Italian marble
Metallic accents
Textured glass
European plumbing fixtures

A

3 BEDROOMS + 3.5 BATHROOMS

Interior 3,327 square feet

Exterior 638 square feet

TOTAL 3,965 square feet

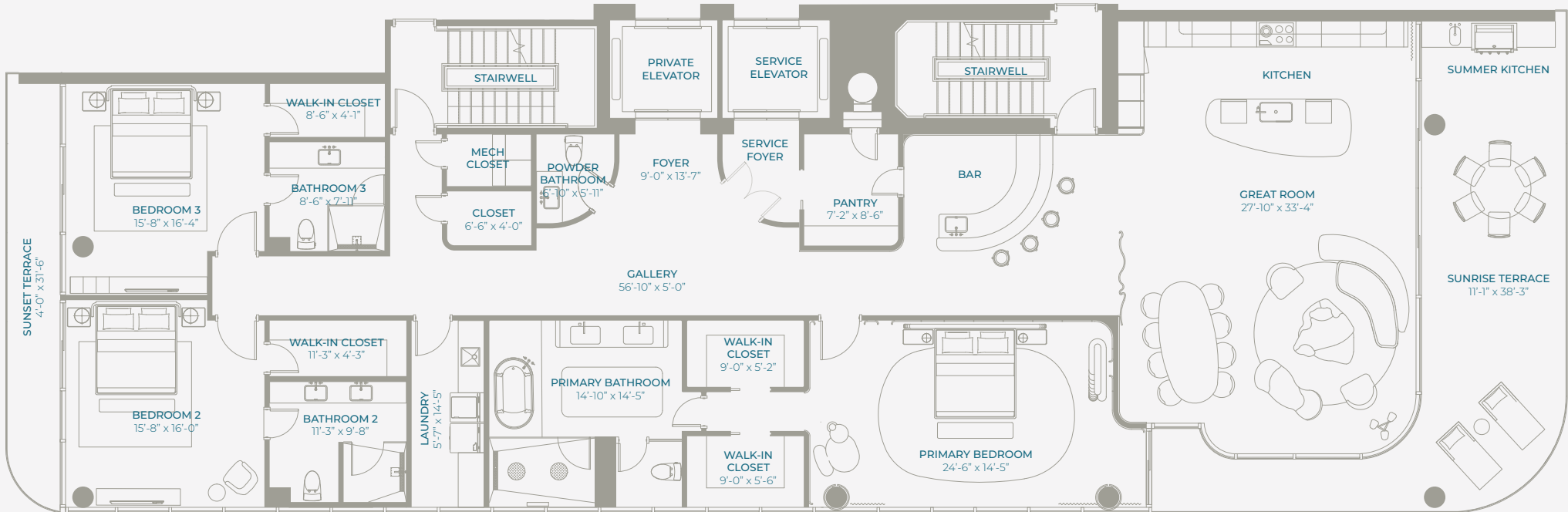

Ocean Avenue

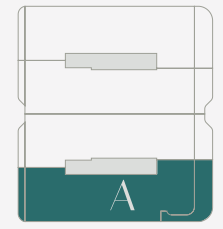

Atlantic Ocean

ARCHITECTURAL FLOORPLANS ARE IN PRELIMINARY DEVELOPMENT STAGE AND ARE SUBJECT TO CHANGE WITHOUT NOTICE. There are various methods for calculating the total square footage of a condominium unit, and depending on the method of calculation, the quoted square footage of a condominium unit may vary by more than a nominal amount. The dimensions stated in these materials are measured to the exterior boundaries of the exterior walls and the centerline of the interior demising walls and, in fact, are larger than the dimensions of the "unit" as defined in the Declaration of Condominium for KANNEGA GLADES LLC which is measured using interior measurements.

D

3 BEDROOMS + 3.5 BATHROOMS

Interior 3,435 square feet

Exterior 530 square feet

TOTAL 3,965 square feet

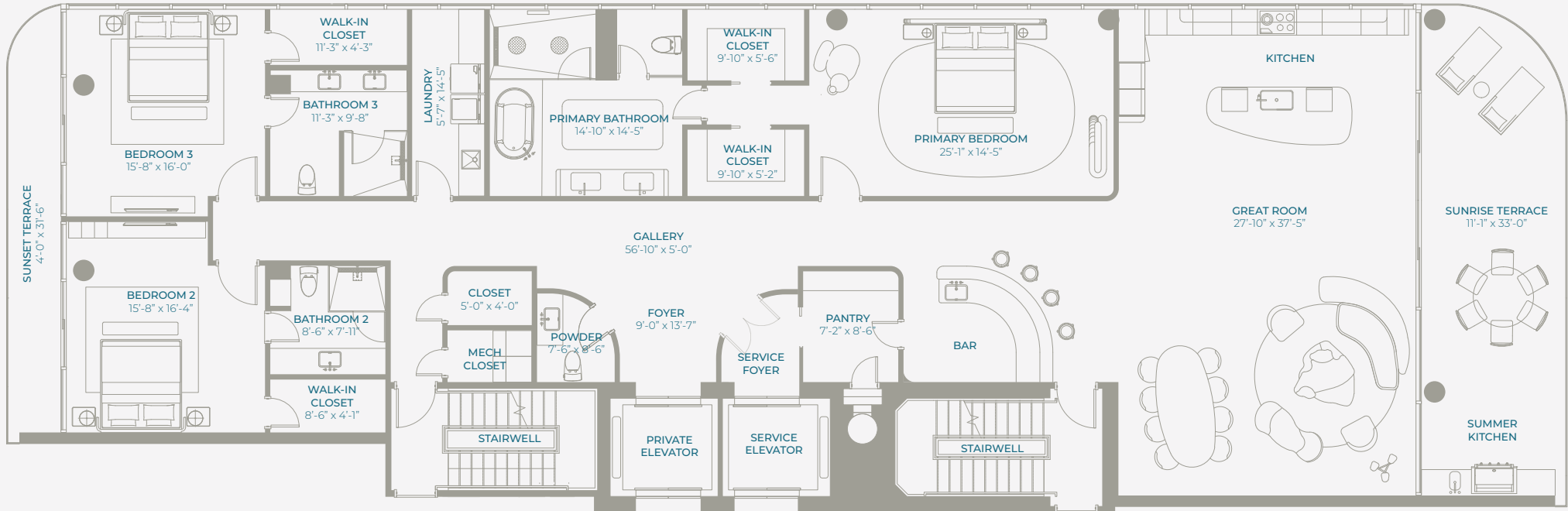

Ocean Avenue

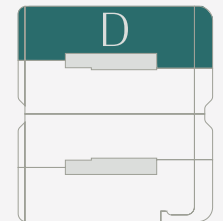

Atlantic Ocean



ARCHITECTURAL FLOORPLANS ARE IN PRELIMINARY DEVELOPMENT STAGE AND ARE SUBJECT TO CHANGE WITHOUT NOTICE. There are various methods for calculating the total square footage of a condominium unit, and depending on the method of calculation, the quoted square footage of a condominium unit may vary by more than a nominal amount. The dimensions stated in these materials are measured to the exterior boundaries of the exterior walls and the centerline of the interior demising walls and, in fact, are larger than the dimensions of the "unit" as defined in the Declaration of Condominium for KANNEGA GLADES LLC which is measured using interior measurements.

A collection of 18 luxury residences with unobstructed Atlantic Ocean views set in a six-story boutique building located in the exclusive enclave of Palm Beach Shores.

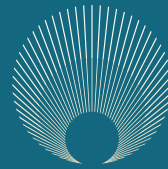

PEARL

PALM BEACH SHORES

123 Ocean Avenue, Palm Beach Shores, Florida 33404

Atlantic Group
of Companies

D | A
A | D



ORAL REPRESENTATIONS CANNOT BE RELIED UPON AS CORRECTLY STATING THE REPRESENTATIONS OF THE DEVELOPER. FOR CORRECT REPRESENTATIONS, MAKE REFERENCE TO THIS BROCHURE AND TO THE DOCUMENTS REQUIRED BY SECTION 718.503, FLORIDA STATUTES, TO BE FURNISHED BY A DEVELOPER TO A BUYER OR LESSEE.

These materials are not intended to be an offer to sell, or solicitation to buy a unit in the condominium. Such an offering shall only be made pursuant to the prospectus (offering circular) for the condominium and no statements should be relied upon unless made in the prospectus or in the applicable purchase agreement. In no event shall any solicitation, offer or sale of a unit in the condominium be made in, or to residents of, any state or country in which such activity would be unlawful. This offering is made only by the prospectus for the condominium and no statement should be relied upon if not made in the prospectus. No real estate broker or salesperson is authorized to make any representations or other statements regarding this project, and no agreements with, deposits paid to, or other arrangements made with any real estate broker are or shall be binding on the Developer. All plans, features and amenities depicted herein are based upon preliminary development plans and are subject to change without notice in the manner provided in the offering documents. No guarantees or representations whatsoever are made that any plans, features, amenities, or facilities will be provided or, if provided, will be of the same type, size, location or nature as depicted or described herein. The sketches, renderings, graphics materials, plans, specifications, terms, conditions, and statements contained in this brochure are proposed only, and the Developer reserves the right to modify, revise or withdraw any or all the same in its sole discretion and without prior notice. All improvements, designs and construction are subject to first obtaining the appropriate federal, state and local permits and approvals for same. These drawings and depictions are conceptual only and are for the convenience of reference. They should not be relied upon as representations, express or implied, of the final detail of the residences. The developer expressly reserved the right to make modifications, revisions and changes it deemed desirable in its sole and absolute discretion. All prices, plans, specifications, features, amenities, and other descriptions are preliminary and are subject to change without notice, as provided in your purchase agreement. All depictions of furniture, appliances, counters, soffits, floor coverings and other matters of detail, including, without limitation, items of finish and decoration, are conceptual only and are not necessarily included in each Unit. Furnishings are only included if and to the extent provided in your purchase agreement. All dimensions are approximate. © Kannega Glades LLC. All Rights Reserved.